



21,975 SF
22nd Floor
Outstanding Water Views

Available December 2026

W ONE
MARITIME PLAZA

WORLD CLASS CITY • WORLD CLASS ASSET • WORLD CLASS TENANTS

ONE OF SAN FRANCISCO'S MOST ICONIC TOWERS

CBRE

PROPERTY HIGHLIGHTS



- ◆ 25-story Iconic Tower with incredible water & bridge views
- ◆ Brand new renovated lobby with expansive plaza level garden
- ◆ Direct access to one of the City's largest parking garages
- ◆ Bike storage, showers and lockers
- ◆ 24-hour, 7-day security
- ◆ On-site property management
- ◆ Energy Star & Well Health-Safety rated

EXTENSIVE UPGRADES

BAR SPREZZATURA



EXTENSIVE UPGRADES

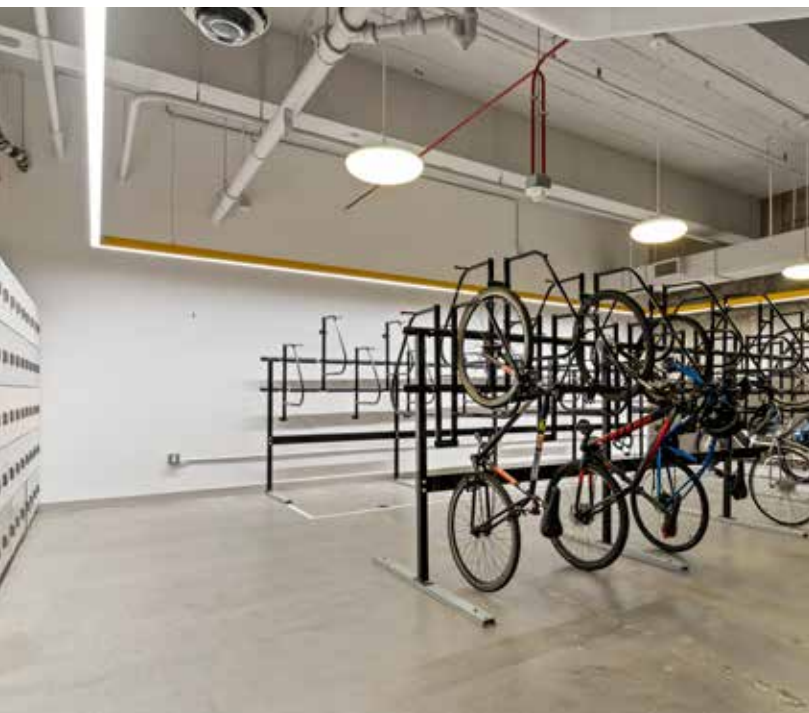

NEIGHBORHOOD



THE BATTERY



FERRY BUILDING



FARMERS' MARKET



BAY CLUB



KOKKARI



THE JAY HOTEL

21,975 RSF

22nd Floor

21,975 RSF

22ND FLOOR
AS-BUILT

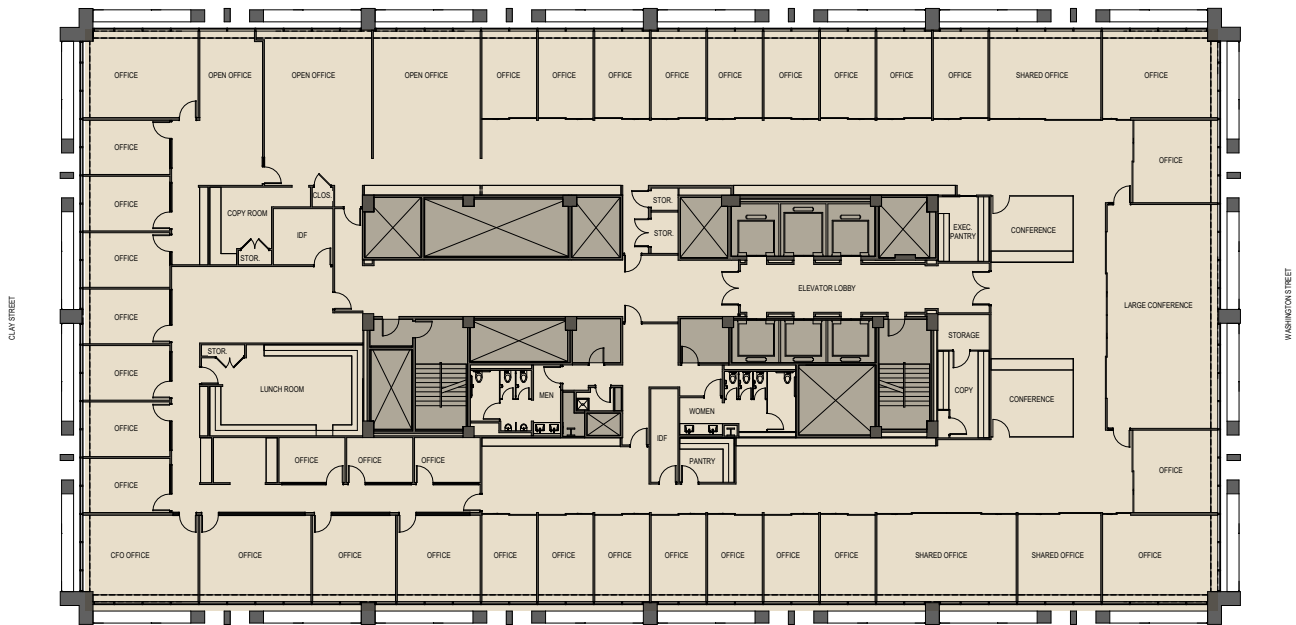

- ◆ Spectacular bridge and water views
- ◆ 32 window-line private offices
- ◆ 3 shared window-line offices
- ◆ 3 interior private offices
- ◆ 1 large conference room
- ◆ 2 small conference rooms
- ◆ Open office areas
- ◆ Large lunchroom
- ◆ Column-free floor plates for maximum efficiency
- ◆ Available December 1, 2026 (potentially sooner)

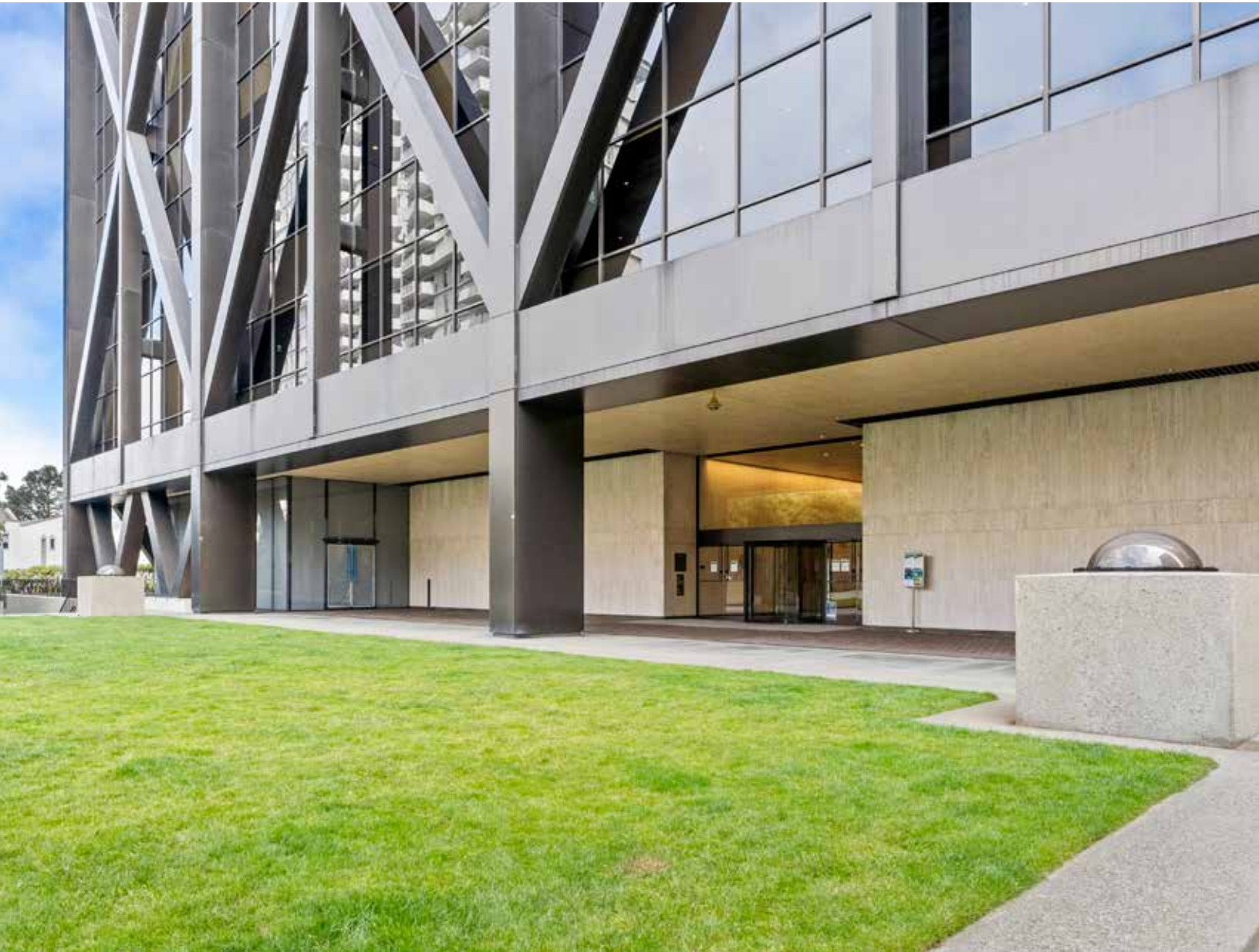

PHIL TIPPETT
LIC. 00849777
+1 415 772 0239
PHIL.TIPPETT@CBRE.COM

CONOR FAMULENER
LIC. 01438818
+1 415 772 0339
CONOR.FAM@CBRE.COM

CBRE
415 MISSION STREET
46TH FLOOR
SAN FRANCISCO, CA 94105



© 2025 CBRE, Inc. All rights reserved. This information has been obtained from sources believed reliable, but has not been verified for accuracy or completeness. You should conduct a careful, independent investigation of the property and verify all information. Any reliance on this information is solely at your own risk. CBRE and the CBRE logo are service marks of CBRE, Inc. All other marks displayed on this document are the property of their respective owners. Photos herein are the property of their respective owners. Use of these images without the express written consent of the owner is prohibited.

